



BT-MD

Modular arbor_모듈러 아바



MAS 403-BT
G6.3
C

Shank G value Coolant System

Fig.1

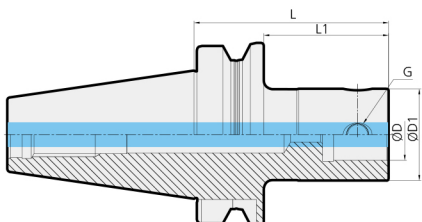
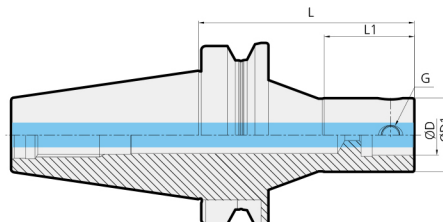

Fig.2



• 관련부품은 **131p** 를 참고하세요.

	형번	ØD	ØD1	L	L1	G	Fig.	Kg	포장무게(Kg)
BT30	BT30-MD19F-70	11	19	70	45	M5	1	0.5	0.5
	BT30-MD25F-90	14	25	90	63	M6	1	0.6	0.7
	BT30-MD32F-80	18	32	80	55	M8	1	0.7	0.7
	BT30-MD40F-45	22	40	45	22	M10	1	0.5	0.6
	BT30-MD40F-60	22	40	60	36	M10	1	0.7	0.7
	BT30-MD40F-80	22	40	80	56	M10	1	0.9	0.9
	BT30-MD50F-70	28	50	70	48	M12	1	0.9	1.0
BT40	BT40-MD19F-70	11	19	70	40	M5	1	1.0	1.2
	BT40-MD25F-95	14	25	95	63	M6	1	1.1	1.3
	BT40-MD25F-105R	14	25	105	40	M6	2	1.2	1.4
	BT40-MD32F-100	18	32	100	70	M8	1	1.2	1.5
	BT40-MD32F-115R	18	32	115	45	M8	2	1.5	1.8
	BT40-MD40F-60	22	40	60	31	M10	1	1.1	1.3
	BT40-MD40F-110R	22	40	110	60	M10	2	1.6	1.9
	BT40-MD40F-115	22	40	115	83	M10	1	1.6	1.8
	BT40-MD50F-105	28	50	105	73	M12	1	1.8	2.1
	BT40-MD63F-64	36	63	64	37	M16	1	1.5	1.7
	BT40-MD63F-110	36	63	110	83	M16	1	2.4	2.6
	BT40-MD63F-135	36	63	135	108	M16	1	3.0	3.3
	BT40-MD80F-100	45	80	100	73	M16	1	2.9	3.1

C 내부 쿨런트 시스템이 탑재되어 있습니다.



BT-MD

Modular arbor_모듈러 아바

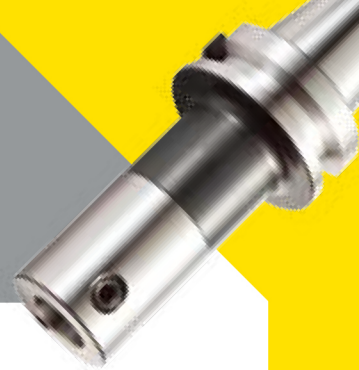

MAS 403-BT G6.3 C
 Shank G value Coolant System

Fig.1

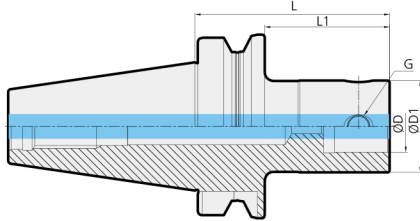
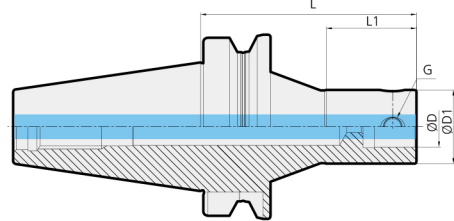

Fig.2



• 관련부품은 **131p** 를 참고하세요.

형번	ØD	ØD1	L	L1	G	Fig.	Kg	포장무게(Kg)
BT50-MD19F-85	11	19	85	44	M5	1	3.7	4.0
BT50-MD25F-105	14	25	105	62	M6	1	3.8	4.1
BT50-MD25F-120R	14	25	120	40	M6	2	3.8	4.1
BT50-MD32F-110	18	32	110	67	M8	1	4.0	4.3
BT50-MD32F-115R	18	32	115	45	M8	2	4.1	4.5
BT50-MD32F-235R	18	32	235	115	M8	2	5.5	5.9
BT50-MD40F-60	22	40	60	22	M10	1	3.7	4.0
BT50-MD40F-195	22	40	195	152	M10	1	4.8	5.2
BT50-MD40F-230R	22	40	230	180	M10	2	5.0	5.4
BT50-MD50F-125	28	50	125	82	M12	1	4.6	5.0
BT50-MD50F-225	28	50	225	182	M12	1	6.0	6.4
BT50-MD50F-250R	28	50	250	81	M12	2	7.0	7.4
BT50-MD63F-75	36	63	75	35	M16	1	4.2	4.5
BT50-MD63F-130	36	63	130	87	M16	1	5.3	5.7
BT50-MD63F-195	36	63	195	152	M16	1	6.8	7.2
BT50-MD63F-230	36	63	230	187	M16	1	7.5	7.9
BT50-MD80F-75	45	80	75	36	M16	1	4.3	4.6
BT50-MD80F-110	45	80	110	69	M16	1	5.7	6.0
BT50-MD80F-175	45	80	175	134	M16	1	8.0	8.4
BT50-MD90F-75	45	90	75	34	M16	1	4.8	5.1
BT50-MD90F-145	45	90	145	104	M16	1	7.4	7.8
BT50-MD90F-195	45	90	195	154	M16	1	9.4	9.8

C 내부 쿨런트 시스템이 탑재되어 있습니다.

Chuck

Arbor / Modular

Boring tool

Angular head

cBN/PCD

Smart factory

TAUMAX

OTHER



HSK-MD

Modular arbor_모듈러 아바



DIN69871
-1A/B
G6.3
C

Shank G value Coolant System

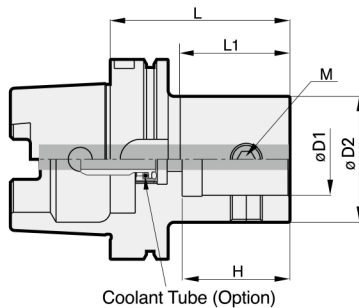

• 관련부품은 **131p** 를 참고하세요.

형번	ØD1	L	ØD2	L1	H	M	Kg	포장무게(Kg)
HSK63A-MD19F-60	11	60	19	31	15.5	M5	0.7	0.9
HSK63A-MD25F-60	14	60	25	31	18.5	M6	0.7	0.9
HSK63A-MD32F-65	18	65	32	36	23.5	M8	0.8	1.0
HSK63A-MD40F-70	22	70	40	41	29	M10	0.9	1.1
HSK63A-MD50F-85	28	85	50	58	36	M12	1.3	1.5
HSK63A-MD63F-95	36	95	63	69	46	M16	1.7	1.9

C 내부 쿨런트 시스템은 옵션 탑재 가능합니다.

별도구매

내부 쿨런트 시스템

상크별 구분	
HSK50	HSK50A-CNS
HSK63	HSK63A-CNS
HSK100	HSK100A-CNS



SK-MD

Modular arbor_모듈러 아바



Fig.1

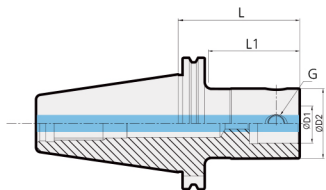

Fig.2

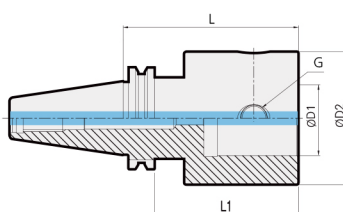
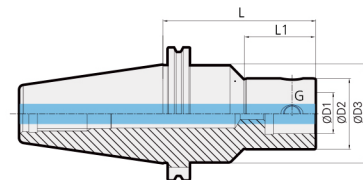

Fig.3



• 관련부품은 **131p** 를 참고하세요.

	형번	ØD1	L	ØD2	ØD3	L1	G	Fig.	Kg	포장무게(Kg)
SK40	SK40-MD19F-80R	11	80	19	30	12	M5	3	1.0	1.2
	SK40-MD25F-80R	14	80	25	35	22	M6	3	1.1	1.3
	SK40-MD32F-115R	18	115	32	42	36	M8	3	1.5	1.7
	SK40-MD40F-60	22	60	40	-	40	M10	1	1.1	1.3
	SK40-MD40F-100	22	100	40	-	80	M10	1	1.4	1.6
	SK40-MD50F-75	28	75	50	-	55	M10	1	1.5	1.7
	SK40-MD50F-100	28	100	50	-	80	M12	1	1.8	2.0
	SK40-MD63F-70	36	70	63	-	50	M16	2	1.4	1.6
SK50	SK50-MD19F-85R	11	85	19	40	12	M5	3	3.0	3.3
	SK50-MD25F-80R	14	80	25	44	22	M6	3	3.1	3.4
	SK50-MD25F-105R	14	105	25	44	22	M6	3	3.3	3.6
	SK50-MD32F-110	18	110	32	-	87	M8	1	3.0	3.3
	SK50-MD32F-110R	18	110	32	50	36	M8	3	3.5	3.8
	SK50-MD40F-100	22	100	40	-	75	M10	1	3.2	3.5
	SK50-MD40F-145	22	145	40	-	120	M10	1	3.5	3.9
	SK50-MD40F-220R	22	220	40	60	83	M10	3	5.6	6.0
	SK50-MD50F-125R	28	125	50	65	60	M12	3	4.3	4.6
	SK50-MD50F-240R	28	240	50	65	125	M12	3	6.6	7.0
	SK50-MD63F-75	36	75	63	-	52	M16	1	3.6	3.9
	SK50-MD63F-130	36	130	63	-	107	M16	1	4.7	5.1
	SK50-MD63F-230R	36	230	63	80	149	M16	3	7.9	8.3
	SK50-MD80F-95	45	95	80	-	75	M16	1	4.8	5.1
	SK50-MD80F-150	45	150	80	-	130	M16	1	6.8	7.2
	SK50-MD90F-115	45	115	90	-	95	M16	2	6.3	6.6
	SK50-MD90F-165	45	165	90	-	145	M16	2	8.1	8.5

C 내부쿨러 시스템이 탑재되어 있습니다.



EXT

Extension bar_익스텐션 바

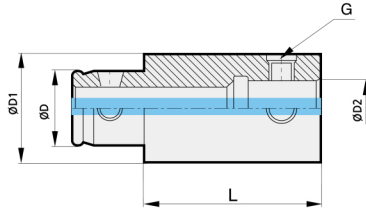

형번	ØD	ØD1	L	ØD2	G	Kg	포장무게(Kg)
EXT1930F	11	19	30	11	M5	0.1	0.1
EXT1950F	11	19	50	11	M5	0.1	0.1
EXT2530F	14	25	30	14	M6	0.1	0.1
EXT2550F	14	25	50	14	M6	0.2	0.2
EXT3235F	18	32	35	18	M8	0.2	0.2
EXT3260F	18	32	60	18	M8	0.4	0.4
EXT4040F	22	40	40	22	M10	0.4	0.4
EXT4090F	22	40	90	22	M10	0.9	0.9
EXT5050F	28	50	50	28	M12	0.7	0.7
EXT50100F	28	50	100	28	M12	1.4	1.5
EXT6360F	36	63	60	36	M16	1.4	1.5
EXT63120F	36	63	120	36	M16	2.9	2.9
EXT8070F	45	80	70	45	M16	2.5	2.7
EXT80120F	45	80	120	45	M16	4.5	4.7
EXT9080F	45	90	80	45	M16	3.8	4.0
EXT90130F	45	90	130	45	M16	6.4	6.6

C 내부 쿨런트 시스템이 탑재되어 있습니다.



RDC

Reducer bar_레듀서 바

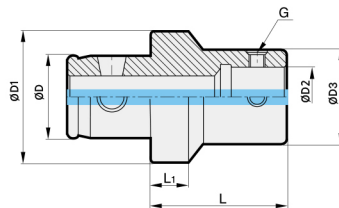

형번	ØD	ØD1	L	ØD2	ØD3	L1	G	Kg	포장무게(Kg)
RDC3225F	18	32	30	14	25	9	M6	0.1	0.2
RDC4025F	22	40	30	14	25	9	M6	0.3	0.3
RDC4032F	22	40	30	18	32	9	M8	0.2	0.2
RDC5025F	28	50	30	14	25	9	M6	0.3	0.4
RDC5032F	28	50	40	18	32	9	M8	0.3	0.4
RDC5040F	28	50	40	22	40	10	M10	0.5	0.6
RDC6325F	36	63	30	14	25	9	M6	0.6	0.7
RDC6332F	36	63	40	18	32	9	M8	0.6	0.7
RDC6340F	36	63	40	22	40	10	M10	0.7	0.8
RDC6350F	36	63	45	28	50	10	M12	0.9	1.0
RDC8040F	45	80	40	22	40	10	M10	1.2	1.4
RDC8050F	45	80	45	28	50	10	M12	1.3	1.5
RDC8063F	45	80	50	36	63	13	M16	1.6	1.8

C 내부 쿨런트 시스템이 탑재되어 있습니다.



기본 구성품

Spare Part		기본 구성품	
타입	이미지	테이퍼 스크류	
형번			
MD19F		BTT0506F	
MD25F		BTT0608F	
MD32F		BTT0810F	
MD40F		BTT1013F	
MD50F		BTT1215F	
MD63F		BTT1620F	
MD80F		BTT1626F	
MD90F		BTT1631F	

별도 구매품

Spare Part		별도 구매품	
클린트 튜브	상크별 구분	렌치	
			
HSK50	HSK50A-CNS	LW-2.5	
HSK63	HSK63A-CNS	LW-3	
HSK100	HSK100A-CNS	LW-4	
		LW-5	
		LW-6	
		LW-8	
		LW-8	
		LW-8	